



City of Chicago



Or2022-343

Office of the City Clerk

Document Tracking Sheet

Meeting Date:	11/4/2022
Sponsor(s):	Reilly (42)
Type:	Order
Title:	Issuance of permits for sign(s)/signboard(s) at 615 S Wabash Ave
Committee(s) Assignment:	Committee on Zoning, Landmarks and Building Standards

CITY COUNCIL
COMMITTEE ON ZONING, LANDMARKS AND BUILDING STANDARDS

COUNCIL ORDER

RE: Approval of sign over 100 square feet in area or over 24 feet above grade

ORDERED, that the City Council hereby approves the following sign application submitted by:

Applicant*: Extra Space Storage

(* The Applicant is the owner of the real property or the business tenant of the real property. Do not list the sign contractor, sign erector, sign company or advertising entity in the above space.)

This Order approves the following sign in accordance with Municipal Code of Chicago Section 13-20-680:

Address of Sign: 615 S Wabash Chicago, IL 60605

Zoning District: DX-12

DOB Sign Permit Application #: 100991365

Sign Details:

1. On-premise OR Off-premise
2. Static sign OR Dynamic-image display sign
3. Number of sign faces 2
4. Projecting over the public way Yes (Yes or No) If yes, Public Way Use #: BACP1742770
5. Dimensions: Length 11 feet 0 inches Height 6 feet 0 inches
Total square feet in area: 66 feet 0 inches
6. Height above grade: 27 feet 0 inches
7. Elevation (side of building or lot where the sign will be erected): West
8. Name of Sign Contractor/Erector: Volkan Signs & Lighting Inc

To be legal, such sign shall comply with all provisions of Title 17 of the Chicago Municipal Code ("Zoning Ordinance") and all other provisions of the Municipal Code governing the permitting, construction and maintenance and removal of signs and sign structures. Failure of the applicant and the applicant's successors to comply shall be grounds for invalidation or revocation of the sign permit.

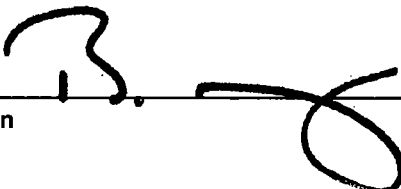
Alderman

42
Ward

Handwritten signature or mark.



EZZI SIGNS
EST. 2003

16611 West Little York Rd
Houston, Texas 77084
EZZISIGNS.COM
1-800-783-7006

PROJECT:
EXTRA SPACE STORAGE

ADDRESS:
615 WABASH AVE
CHICAGO, IL 60605

DATE: 03/11/2022

PROJECT NUMBER:
ES-3037

DESIGNER:
RAMON

REVISIONS
R1: 00/00/2021
DESIGN UPDATE
R2: 00/00/2021
DESIGN UPDATE
R3: 00/00/2021
DESIGN UPDATE

APPROVALS / DATE
CLIENT:

LANDLORD:



Installation requirement. This sign to be installed in accordance with the requirements of article 600 of the national electric code and other applicable local codes. This includes proper grounding and bonding of the sign.

All conceptual renderings are property of Ezzi Signs. Any reproduction, exhibition or use of this drawing is strictly prohibited. ©2020 All rights reserved.

B

QTY: 2 FACES

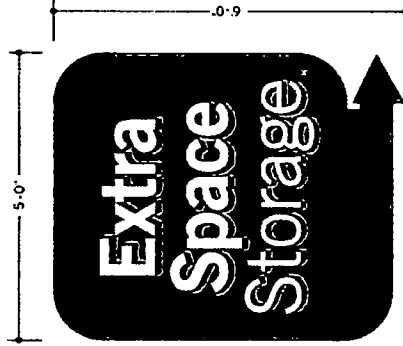

NEW FACES: TRANS WHITE POLYCARBONATE
PAINT: SW 7067 CITY SCAPE
WHITE GREEN 2500-106 BRILLIANT
BLACK 2500-022

ILLUMINATION: VEROY INTERIOR LIGHTING FOR UPGRADE TO LEDS
*PAINT EXISTING CABINET & SUPPORT GRAY

UPDATED ELEVATION
SCALE: 1/4" = 1'-0"

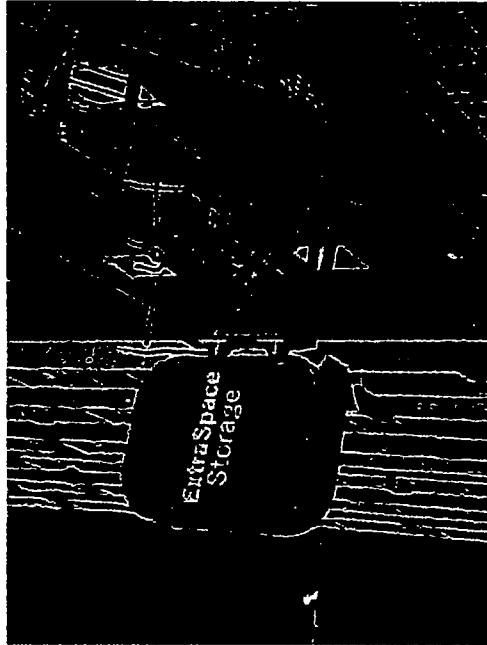
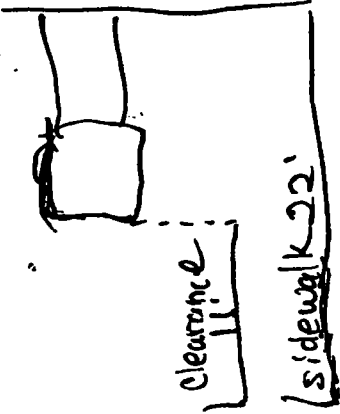

CURRENT ELEVATION
SCALE: NTS