



City of Chicago



Or2010-1078

Office of the City Clerk

Document Tracking Sheet

Meeting Date:	10/6/2010
Sponsor(s):	Allen (38)
Type:	Order
Title:	Issuance of permits for sign(s)/signboard(s) at 3632 N Cicero Ave - 200 sq. ft.
Committee(s) Assignment:	Committee on Buildings

City Council
Meeting Date: 10/6/10
Committee on Buildings

(signs)

ORDERED, That the Commissioner of Buildings is hereby directed to
issue a sign permit to: (Contractor's name and address)

AD DELUXE SIGN COMPANY, INC.

5540 W. Harrison St.

Chicago, IL 60644

for the erection of a sign / signboard over 24 feet in height and / or over 100
square feet (in area of one face) at: (Business NAME & ADDRESS)

.carrosenpagos.com

3632 North Cicero Avenue

Chicago, IL 60641

Dimensions: Length 5'-0" Height 40' - 0"

Height above grade / roof to top of sign 15' - 0"

TOTAL SQUARE FOOT AREA 200 sq. ft.

Such sign(s) shall comply with all applicable provisions of TITLE 17 of the
Chicago Zoning Ordinance and all other applicable provisions of the Municipal
Code of the City of Chicago governing the construction and maintenance of
outdoor signs, signboards and structures.

Thomas R. Allen
Alderman, 38th Ward

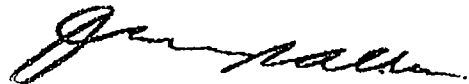

Document No. PO2010- **988**

REFERRED TO COMMITTEE ON BUILDINGS
OCT - 6 2010
<i>Michael D. D. D.</i> City Clerk



CITY OF CHICAGO

DEPARTMENT OF BUILDINGS

Sign Permit Application

APPROVAL NUMBER 19032	APPLICATION NUMBER 100345656	ANNUAL FEE	WORK CODE	DRAWINGS ATTACHED <input type="checkbox"/> YES <input type="checkbox"/> NO
DATE OF APPLICATION 05/24/2010		TYPE OF SIGN FLAT OR BOX		
ADDRESS OF SIGN 3632 N CICERO AVE, 60641-		LENGTH 40	FT. 0	IN. 0
BUILDING	ORIGINAL PERMIT NUMBER	HEIGHT 5	FT. 0	IN. 0
TYPE OF PERMIT NEW CONSTRUCTION (SIGN)		AREA 200	SQ. FT. 200	WEIGHT 250
PAYER OF ANNUAL INSPECTION FEE HORWITZ, AVE 3632 N CICERO AVE CHICAGO, IL 60641 (773)931-8000		SIGN HEIGHT ABOVE GRADE/ROOF 10		FT. 10
SIGN MANUFACTURER AD DELUXE SIGN CO		SHAPE OF SIGN REGULAR		
ADDRESS WHERE SIGN CAN BE SEEN PRIOR TO ERECTION		SIGN WILL READ CARROSENPAGOS.COM		
TICKET NUMBER 0	REINSPECTION CONTROL NUMBER	NO. OF LAMPS 4	TOTAL WATTAGE 1600	
TYPE OF SUPPORT FOR SIGN BUILDING		TYPE OF LAMP HIGH DENSITY DISCHARGE		
SIGN BOARD SUPPORT MEMBERS STEEL		NO. OF BALLAST/TRANSFORMERS 4	INPUT OF TRANSFORMERS 110	
ANNUAL FEE		CONTRACTOR WILL INSTALL <input checked="" type="checkbox"/> FEEDERS <input checked="" type="checkbox"/> CUSTOMER LEADS		
CONSTRUCTION FEE	200.00	TYPE OF SWITCH KNIFE		
1017 B FEE		LOCATION OF SWITCH OUTSIDE SIGN		
TOTAL FEE	200.00	SIGN LOCATION FURNISH AND INSTALL 5' X 40 SINGLE FACE BANNER WITH ILLUMINATED WITH FOUR 400 WATT MEDAL HALIDE FIXTURE ON PATTERSON SIGN		
AMOUNT PAID	200.00			
BALANCE DUE				

The undersigned certify that the statements in this application are true and correct and that all work done under the proposed permit will conform to the requirements of the Chicago Municipal Code

REG. NO	E68756
ELECT CONTR	FULLER-BURRELL ELECTRIC CONTRA
ADDRESS	1424 N. LUNA AVE. CHICAGO, IL 60651-
SUPERVISOR SIGNATURE	<i>Sam Burrell</i>

BOND NO.	REG. NO	N92559
SIGN ERECTOR	AD DELUXE SIGN CO INC.	
ADDRESS	5540 WEST HARRISON CHICAGO IL, 60644	
SIGNATURE	<i>Alan D.</i>	

The permit issued on this application will authorize only signs here applied for. If other signs are to be erected they must be covered by additional permits

City of Chicago
Richard M. Daley, Mayor



z/r

Department of Buildings
Richard Monocchio, Commissioner

TYPE OF BUSINESS <u>COMMERCIAL</u> Other: <u>CAR DEALER</u> Name: <u>LEONS AUTO SALES</u> LIC #: <u>72166</u> Renewal Date: _____	SIGN BOND REQUIRED? <input type="checkbox"/> YES COUNCIL ORDER REQUIRED <input checked="" type="checkbox"/> YES IS SPECIAL PERMISSION REQUIRED FROM CHIEF ELECTRICAL INSPECTOR? <input checked="" type="checkbox"/> YES IF YES, ATTACH LETTER OF REQUEST
Projects Over: <input checked="" type="checkbox"/> Private Property <input checked="" type="checkbox"/> Public Way Grant Permit #: <u>1091864</u> <input type="checkbox"/> Planned Development/Manufacturing PMD/PD#: _____ Zoning District: <u>C1</u> Other: <u>C1-1</u>	TIME STAMP
TYPE OF SIGN: <input type="checkbox"/> ADVERTISING <input checked="" type="checkbox"/> ILLUMINATED <input type="checkbox"/> MOVEABLE <input checked="" type="checkbox"/> BUSINESS <input type="checkbox"/> FLASHING	
TOTAL STREET FRONTAGE OF LOT (IN FEET) <u>300</u> TOTAL AREA OF NEW SIGN (SQ.FT.) <u>200</u> TOTAL AREA OF ALL SIGNS ON LOT (SQ.FT.) <u>414</u> HEIGHT OF SIGN ABOVE GRADE (TO TOP) <u>15ft 0in</u>	
DISTANCE OF CURB LINE OUTER EDGE (ft) <u>11</u> DISTANCE OF STRUCTURE INNER EDGE (ft) <u>12</u>	SIGN CLERK _____ APPROVED FOR PERMIT _____
DISTANCE FROM (ft). A. PUBLIC PARK (OVER 10 ACRES) <u>1,000</u> B. EXPRESSWAY (IF LESS THAN 1,000 FT) <u>1,000</u> C. RESIDENCE DISTRICT (ADVERTISING SIGNS ONLY) <u>150</u>	REMARKS
IF REPLACEMENT SIGN OR CHANGE OF FACE, WHAT DOES THE EXISTING SIGN READ? Original Payee: _____	
Landmark Hold: <input type="checkbox"/> Status: _____	
ZONING (OFFICE USE ONLY) <div style="text-align: center;"> <p>CONFORMS TO ZONING ORDINANCE This Approval of Application for signs shall not be held to permit or be an approval of any violation of the provisions.</p> <p>AUG 03 2010</p> <p>of the Chicago Zoning Ordinance, or any other requirements of the Municipality Code of the City of Chicago ZONING ADMINISTRATOR</p> </div>	

40'

carrosenpagos.com



Ad Deluxe Sign Co.
5540 West Harrison
Chicago, IL 60644
ADDELUXESIGN@comcast.net
phone : 773-378-4548
fax: 773-378-4552

PATTERSON ELEVATION
3632
THE AUTO WAREHOUSE
~~3632~~ **NORTH CICERO AVE**
CHICAGO, IL 60639

Appt# 100345656

CITY OF CHICAGO
DEPARTMENT OF ZONING AND LAND USE PLANNING
SIGN SITE PLAN
(ALL INFORMATION MUST BE COMPLETED AND LEGIBLE)

Site Address: 3632-36 N. CICERO AVE 2 of 3 applications

Sign Company: AD DELUXE SIGN CO Rep Name: John Miller

Phone (773) 378-4548 EXT _____ (Below: Building, streets and location of sign on lot or structure)
North

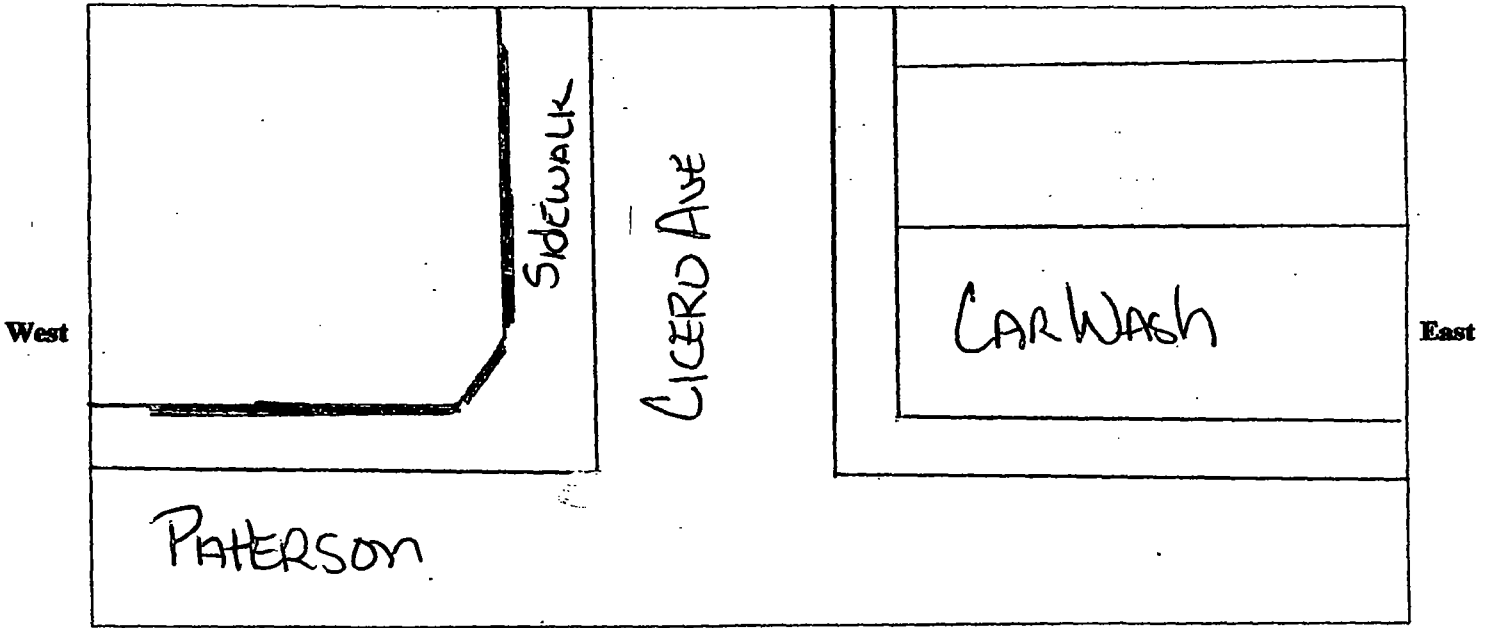

South

SIGN USE:

- Bus. ID (On-premise)
- Business Lice. # 721106
- Advertising (Off-premise)

PERMIT TYPE:

- New Construction
- Change of Face
- Previous Permit #

TYPE OF SIGN:

- Flat Wall
- Freestanding
- Awning
- Marquee
- High Rise Building
- Projecting Private
- Projecting Public Way
- Public Way Use -Permit # 109186A

SIGN CHARACTERISTICS:

- Non-Illuminated
- Illuminated
- Changing Image
- Video Display
- Flashing

DISTANCE FROM:

- Curb Line: 12
- Expressway, Toll Roads or Major Route 150
- (n/a if over 1000 ft) 1000
- Park (over 10 acres) 1000
- Residential Zone NO
- Existing Off-premise on same side of street: _____

TOTAL SQUARE FOOTAGE:

- Square footage of this proposed sign 200
- Gross area of all proposed signs 414
- Area of all existing signs 414
- (not including proposed) on Zoning Lot C-1

Signature: [Handwritten Signature]

Date: May 21, 2010

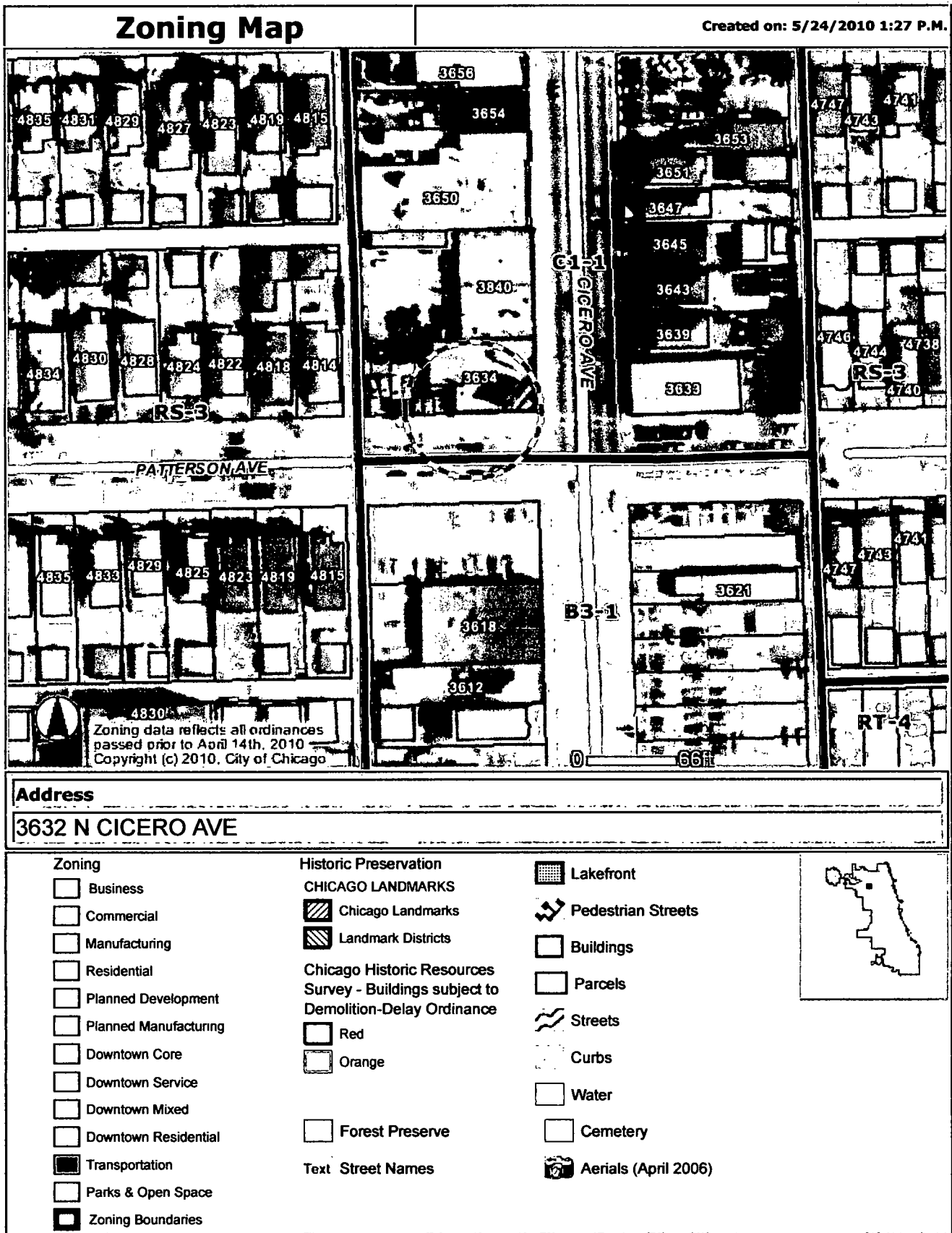

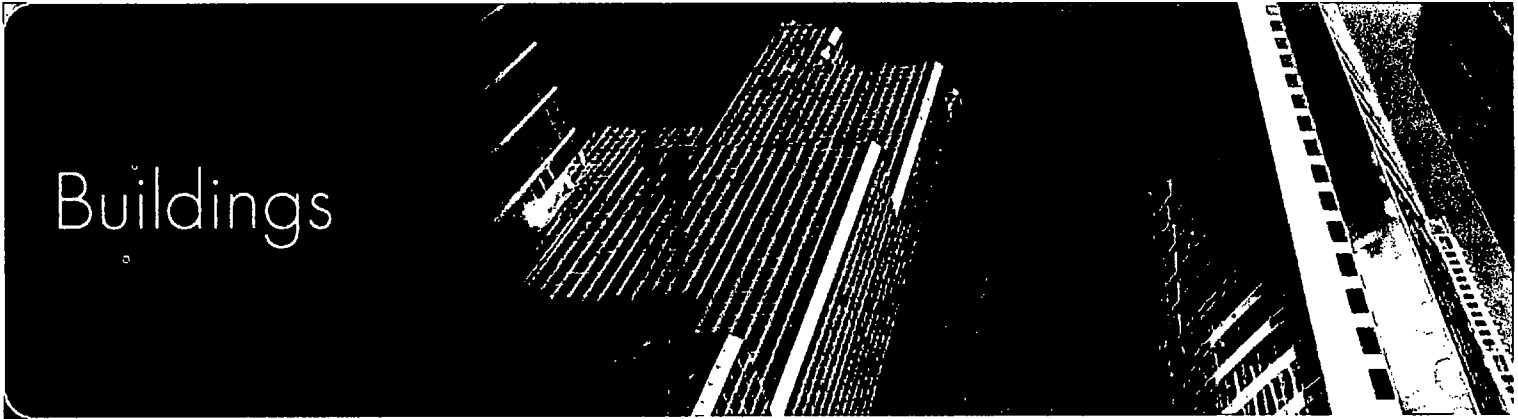
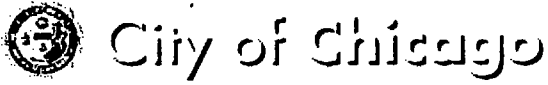

Online Permits &
Trade License Renewals

Public Services

Online Planning

Application Center

City of Chicago

- 1. Type
- 2. Location Info
- 3. Description
- 4. Details
- 5. Contractors
- 6.

Payment Confirmation

Thank you for using the City of Chicago Online Permitting.
Please keep this information as verification of payment.

App #	Date	Type	Description	Fee
+ 100345640	5/24/2010	Sign	3632 N CICERO AVE 60641-	\$200.00
+ 100345656	5/24/2010	Sign	3632 N CICERO AVE 60641-	\$200.00
+ 100345662	5/24/2010	Sign	3632 N CICERO AVE 60641-	\$200.00

Total:

PAYMENTCONFIRMATION

Payment Transaction #: **50289**

Your Credit Card has been charged **\$600.00**

Authorization # **024845**

Reference # **2699351**

If you are having trouble with the website, please contact the City of Chicago by calling 311 to report a technician will respond within one business day. If you are located outside of the city limits, please ca

ZONE Classification	Ordinance Number	Ordinance Date	
C1-1			
TIF			
Belmont/Cicero			
Building Id	From Add	To Add	Dir Street Type Stories Units Built Sq.Ft. Condition Vacancy
847820	3634	3634	N CICERO AVE 1 1925 SOUND
Map Index		Page Number	
9-L		52B	
PIN	From Address	To Address	Dir Street Type Suffix
Cook County Assessor Cook County Recorder of Deeds CNT 13212270320000	3634	3634	N CICERO AVE
Ward	Alderman	Phone	Address
38	THOMAS R. ALLEN	773-545-3838	5817 W IRVING PARK RD

Close Window

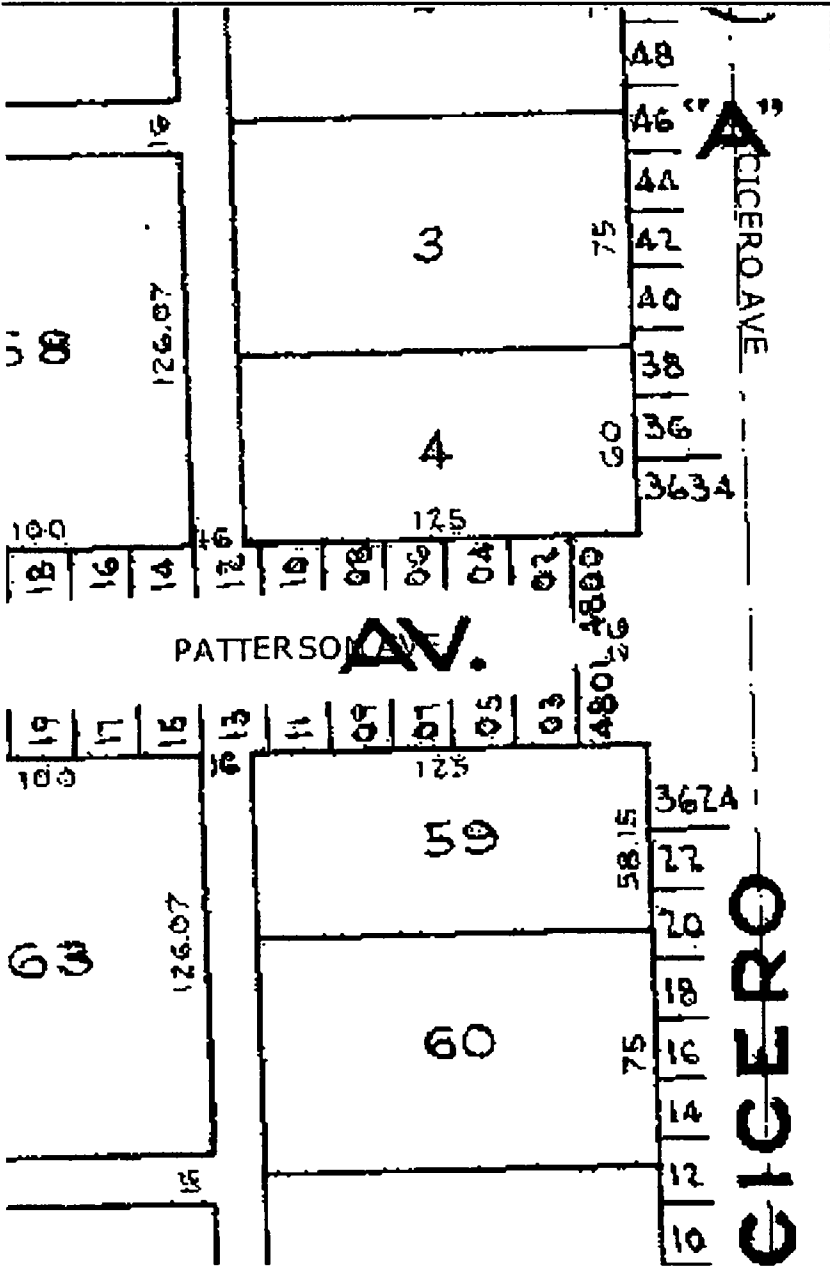

This map is a public resource of general information. The City of Chicago makes no warranty, representation or guaranty as to the content, sequence, accuracy, timeliness or completeness of any of the database information provided herein. The reader should not rely on the data provided herein for any reason. The City of Chicago explicitly disclaims any representations and warranties, including; without limitation, the implied warranties of merchantability and fitness for a particular purpose. the City of Chicago shall assume no liability for: 1. any errors, omissions, or inaccuracies in the information provided regardless of how caused; or 2. any decision made or action taken or not taken by the reader in reliance upon any information or data furnished hereunder. Map Copyright (c) 2007-2017 City of Chicago



PUBLIC WAY USE UNIT: PERMIT INFORMATION SHEET

05/24/2010 - Lisa Pusateri

DBA Name THE AUTO WAREHOUSE

Location 3632-36 N. CICERO AVE.

Zip Code 60641

Account Number 21789

Site Number 1

Area PERMIT

Permit Type BANNER

Permit Number 1091864

Next steps: Department of Buildings – Permit process for signs

Your Public Way Use permit number is shown above. This number is to be used for each item on your DOB application and is needed for the Buildings (DOB) online sign application located @ www.cityofchicago.org/buildings. All signs, canopies, banners, marquees and awnings require a buildings permit. Only a licensed sign erector may apply for the Buildings permit online. The Buildings permit application will ask for the Public Way Use permit number supplied above. For additional information please contact the Buildings Department at (312) 744-3400.

Please return the completed Public Way Use application to City Hall - 121 N. LaSalle Street, Chicago, IL 60602 Room 800. The completed application package must include a copy of the completed DOB application and the Public Way Use application. The Public Way Use application must contain the Alderman's signature, site plans on 8 1/2 X 11 paper, photos of the item(s), the signed Acceptance letter and a copy of the insurance certificate. For additional information please contact BACP at (312)-74-GOBIZ (312-744-6249).

CITY OF CHICAGO

LICENSE CERTIFICATE

NON-TRANSFERABLE

BY THE AUTHORITY OF THE CITY OF CHICAGO, THE FOLLOWING SPECIFIED LICENSE IS HEREBY GRANTED TO

NAME: **LEON'S AUTO SALES INC**

DBA: **THE AUTO WAREHOUSE**
AT: **3632-3636 N. CICERO AVE.**
CHICAGO, IL 60641
1ST

LICENSE NO.: **72166** CODE: **1010**

FEE: **\$****250.00**

LICENSE: **Limited Business License**

PRESIDENT: **AVE D. HORWITZ**
SECRETARY: **RONIT HOROWITZ**

PRINTED ON : **07/27/2009**

\$**250.00**

THIS LICENSE IS ISSUED AND ACCEPTED SUBJECT TO THE REPRESENTATIONS MADE ON THE APPLICATION THEREFOR, AND MAY BE SUSPENDED OR REVOKED FOR CAUSE AS PROVIDED BY LAW. LICENSEE SHALL OBSERVE AND COMPLY WITH ALL LAWS, ORDINANCES, RULES AND REGULATIONS OF THE UNITED STATES GOVERNMENT, STATE OF ILLINOIS, COUNTY OF COOK, CITY OF CHICAGO AND ALL AGENCIES THEREOF.

WITNESS THE HAND OF THE MAYOR OF SAID CITY AND THE CORPORATE SEAL THEREOF

THIS **15** DAY OF **AUGUST**, **2009**

EXPIRATION DATE:

August 15, 2011

ATTEST:



Riudal M Daley
MAYOR

Miguel del Valle
CITY CLERK

DREV NO **21789** SITE: **1**
TRANS NO.



THIS LICENSE MUST BE POSTED IN A CONSPICUOUS PLACE UPON THE LICENSED PREMISES.

THE FACE OF THIS DOCUMENT HAS A MULTI-COLORED DOCUMENT ON WHITE PAPER

5/8" (D) X 3" (L) LAG SHEILD AND
5/8" (D) X 4" LAG BOLT WITH
WASHER

1/2" J BOLT WITH
WASHER AND NUT

1/2" MT LIGHT WALL
GALVANIZED TUBING



2
A-1

BANNER CLIP DETAIL
NOT TO SCALE

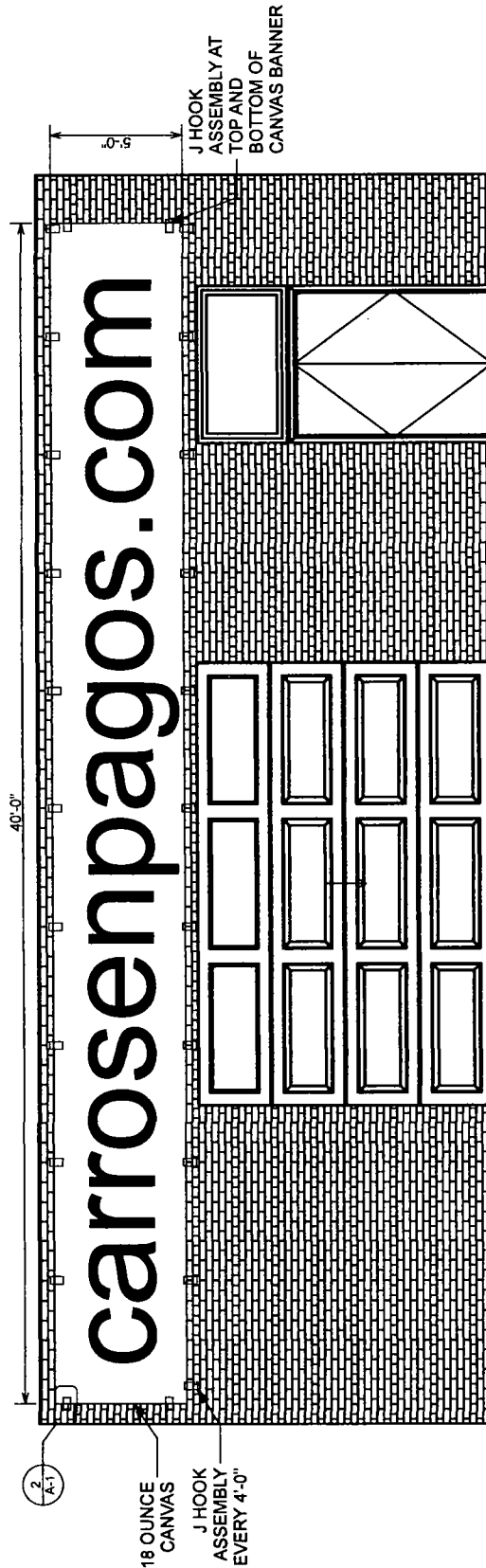

1
A-1

WEST PATTERSON ELEVATION
NOT TO SCALE

PERMIT APP. NUMBER: 100345656
APPROVAL NUMBER: 19032
TOTAL AREA: 200 SQ. FT.
STREET FRONTAGE: 300'-0"
SIGN TO READ: CARROSENPAPOS.COM
SHEET A-1

SCOPE OF WORK:
INSTALL 5'-0" x 40'-0" ILLUMINATED
CANVAS SIGN

CLIENT DATA:
LEON AUTO SALE
HORWITZ, AVE
3632 NORTH CICERO AVE.
CHICAGO, ILLINOIS 60641
PHONE (773) 931-3000

AD DELUXE SIGN COMPANY, INC
5540 WEST HARRISON STREET
CHICAGO, ILLINOIS 60644
PHONE: 773-378-3538
FAX: 773-378-4552
Email: ADDELUXESIGN@comcast.net